



"VERIS V3" GLAZED ALUMINUM DOOR SINGLE w/ or w/out SIDELITE(S) OUTSWING "IMPACT"

GENERAL NOTES

- This product has been evaluated and is in compliance with the 8th Edition (2023) Florida Building Code (FBC) structural requirements including the "High Velocity Hurricane Zone" (HVHZ).
- Product anchors shall be as listed and spaced as shown on details. Anchor embedment to base material shall be beyond wall dressing or stucco.
- When used in the "HVHZ", this product complies with Section 1626 of the Florida Building Code and does not require an impact resistant covering.
- For 2x stud framing construction, anchoring of these units shall be the same as that shown for 2x buck masonry construction.
- Site conditions that deviate from the details of this drawing require further engineering analysis by a licensed engineer or registered architect.
- This product does not meet the water infiltration requirements for the "HVHZ" and shall be installed only in non-habitable areas or at habitable locations protected by an overhang or canopy such that the angle between the edge of canopy or overhang to sill is less than 45 degrees.
- Aluminum components, including fasteners, shall meet the requirements of FBC Section 2003.
- Gaskets shall comply with FBC Section 2411.3.4.

| TABLE OF CONTENTS | |
|-------------------|--|
| SHEET # | DESCRIPTION |
| 1 | Typical Elevations, Design Pressures & General Notes |
| 2 | Door & Sidelite Panels & Glazing Details |
| 3 | Elevations |
| 4 | Horizontal & Vertical Cross Sections (2X Buck) |
| 5 | Horizontal Cross Sections (2X Buck) |
| 6 | Horizontal & Vertical Cross Sections (1X Buck) |
| 7 | Horizontal & Vertical Cross Sections (Direct to Masonry) |
| 8 | Horizontal Cross Sections |
| 9 | Vertical Cross Sections |
| 10 | Buck Anchoring |
| 11 | Frame Anchoring |
| 12 | Bill of Materials & Components |

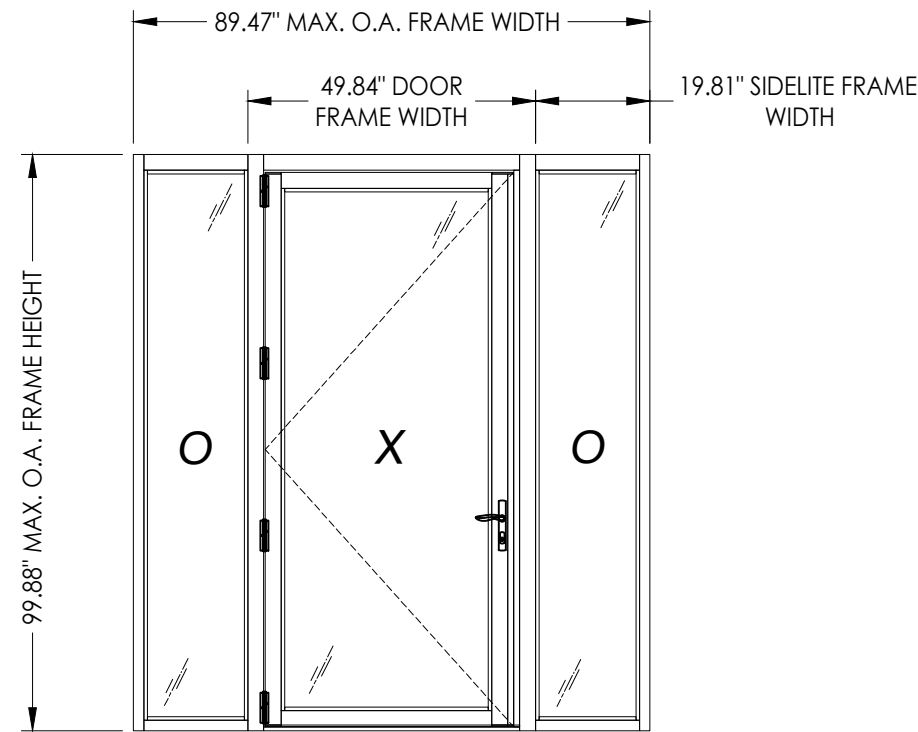
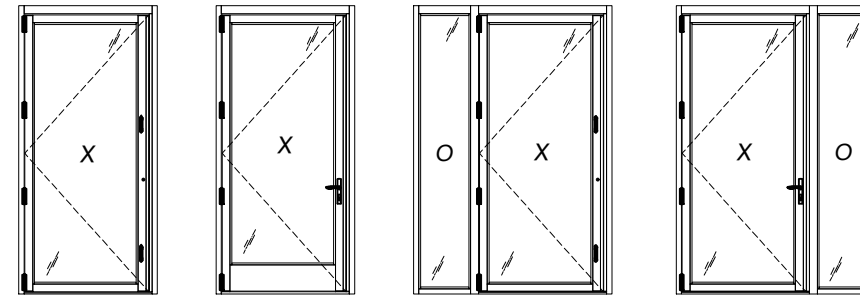

| CONFIGURATION | MAX. FRAME DIMENSION | DOOR MAX. D.L.O. | SIDELITE MAX. D.L.O. | DESIGN PRESSURE (PSF) | |
|---------------|----------------------|------------------|----------------------|-----------------------|----------|
| | | | | POSITIVE | NEGATIVE |
| X | 47.97" x 99.88" | 35.25" X 89.25" | N/A | +50.0 | -50.0 |
| OX/XO | 68.72" x 99.88" | 35.25" X 89.25" | 16.75" X 94.06" | +50.0 | -50.0 |
| OXO | 89.47" x 99.88" | 35.25" X 89.25" | 16.75" X 94.06" | +50.0 | -50.0 |

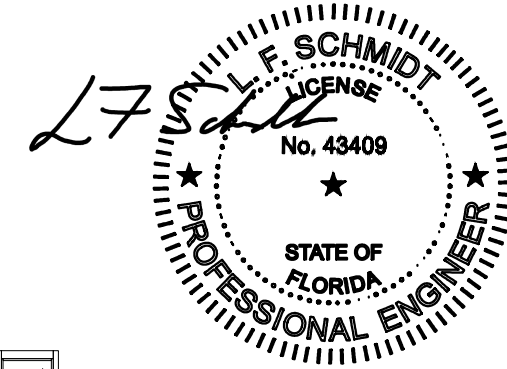

This item has been digitally signed and sealed by L. F. Schmidt, P.E. on the date adjacent to the seal. Printed copies of this document are not considered signed and sealed and the signature must be verified on any electronic copies.

THIS PRODUCT APPROVAL IS VALID ONLY FOR THE STATE OF FLORIDA

Documents Prepared By: Lyndon F. Schmidt
P.E. No. 43409

RW BUILDING CONSULTANTS, INC.
P.O. Box 230, Valrico, FL 33595
Phone No.: 813.659.9197
FBPE Registry No. 9813

PRODUCT: THERMA TRU
PART OR ASSEMBLY: TYPICAL ELEVATION, DESIGN PRESSURES & GENERAL NOTES

| NO. | DATE | BY | REVISIONS |
|-----|------|----|-----------|
| | | | |

DATE: 2/07/24
SCALE: N.T.S.
DWG. BY: LFS
CHK. BY: RW
DRAWING NO.: FL-46172.9
SHEET 1 OF 12

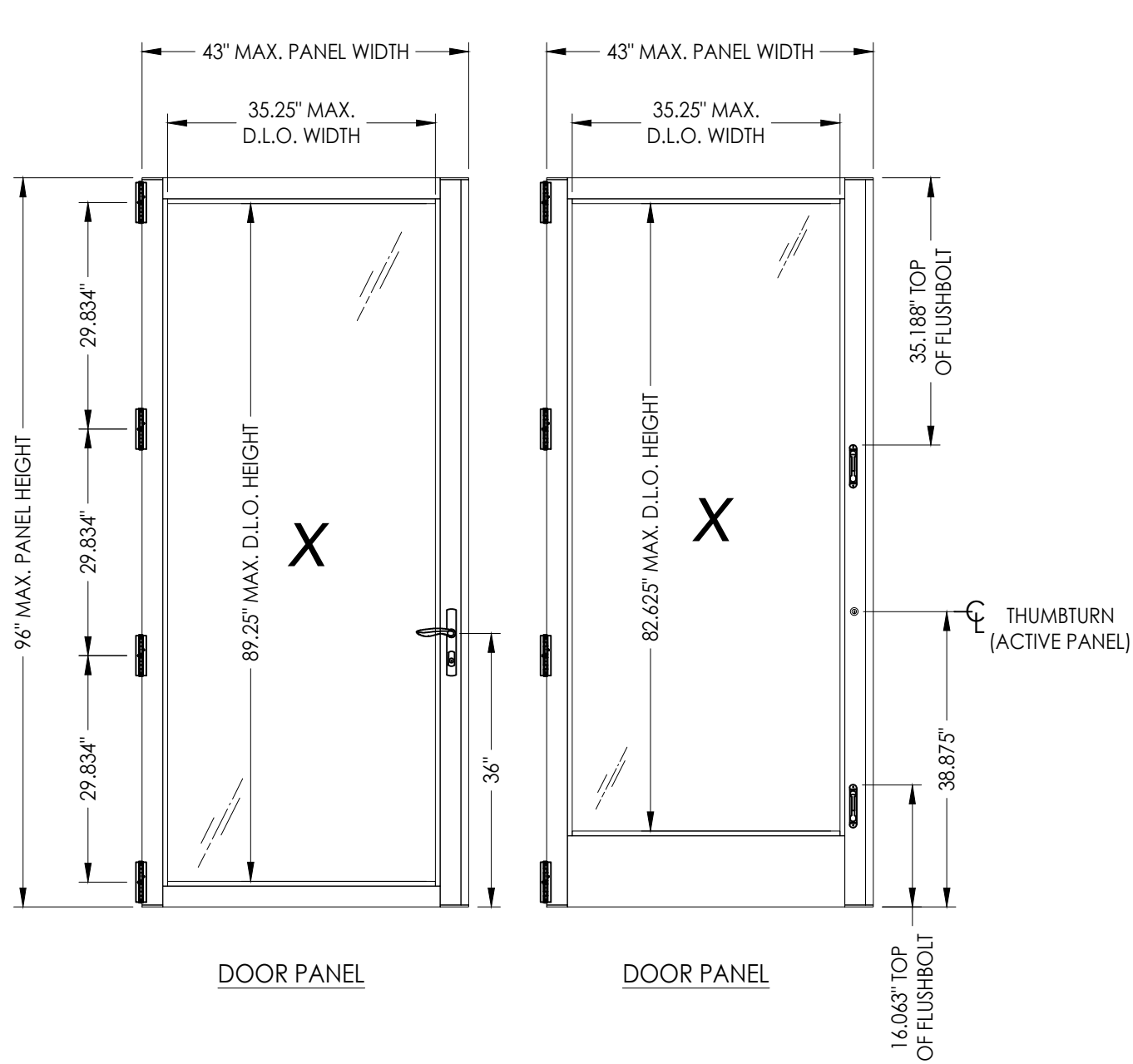

DOOR PANEL

DOOR PANEL

SIDELITE PANEL

16.063" TOP OF FLUSHBOLT

THUMBTURN (ACTIVE PANEL)

| HARDWARE TABLE | |
|------------------------|--|
| MANUFACTURER | MODEL |
| HOPPE | HOPPE HLS9000 ACTIVE: LEVER w/ 3 pt. LOCK |
| ADAMS RITE | ACTIVE: THUMBTURN & KEYED CYLINDER MS+ 1890 SERIES DEADBOLT |
| TERRY HINGE & HARDWARE | ACTIVE: FLUSHBOLTS |

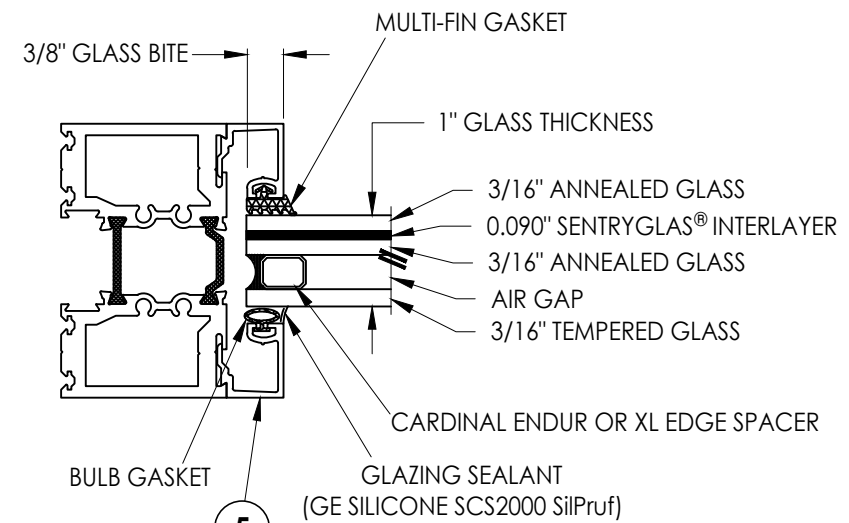

G1 GLAZING DETAIL

NOTE: GLAZING > 36" WIDE REQUIRES AT LEAST TWO (2) SETTING BLOCKS CONFORMING TO FBC SECTION 2411.3.3.1.

Documents Prepared By:
Lyndon F. Schmidt
P.E. No. 43409

RW BUILDING CONSULTANTS, INC.
P.O. Box 230, Valrico, FL 33595
Phone No.: 813.659.9197
FBPE Registry No. 9813

PRODUCT: THERMA-TRU

PART OR ASSEMBLY:
DOOR & SIDELITE PANELS &
GLAZING DETAILS

| NO. | DATE | BY | REVISIONS |
|-----|------|----|-----------|
| | | | |
| | | | |
| | | | |
| | | | |

DATE: 2/07/24
SCALE: N.T.S.
DWG. BY: LFS
CHK. BY: RW
DRAWING NO.: FL-46172.9
SHEET 2 of 12

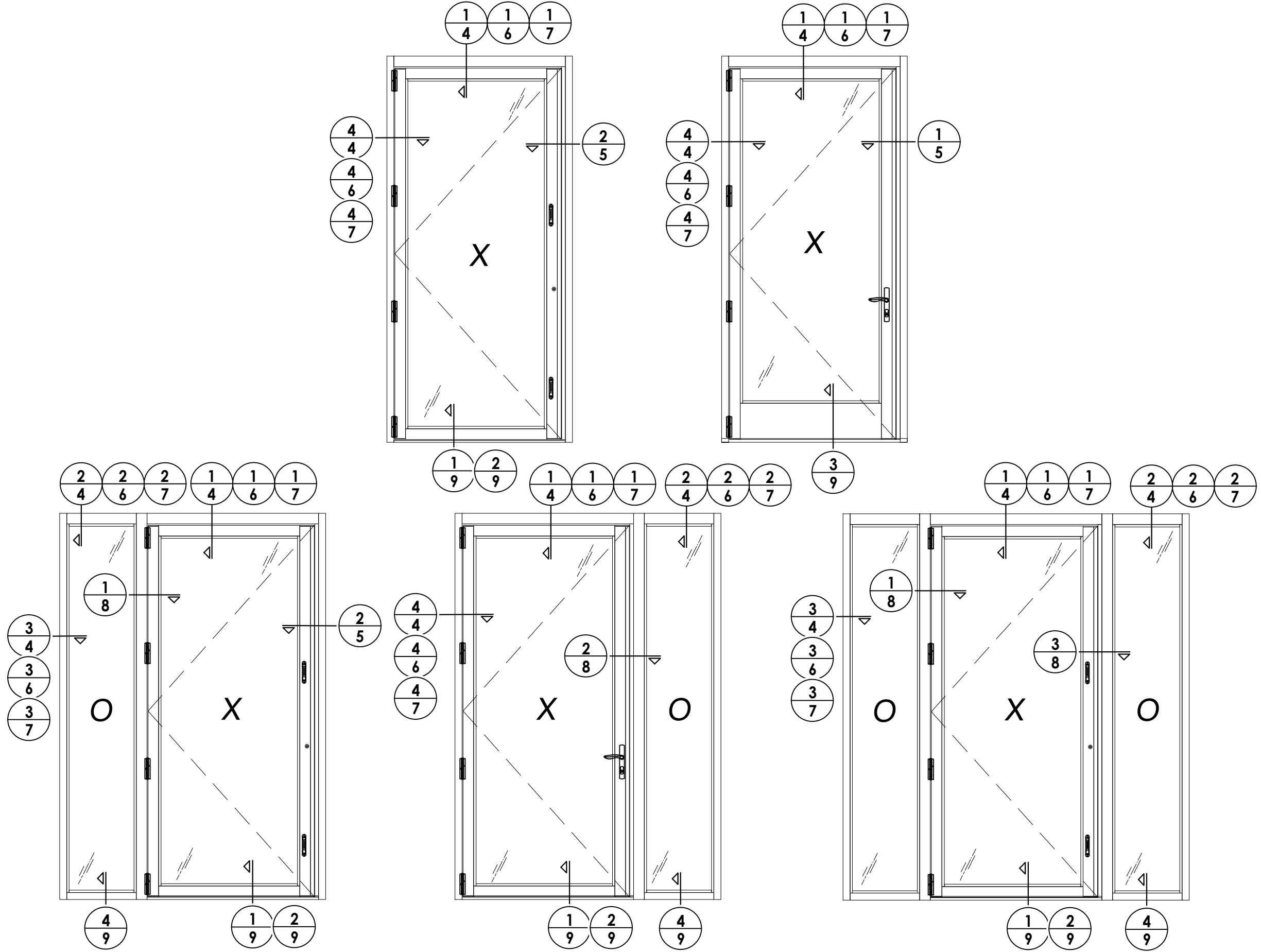

Documents Prepared By:
Lyndon F. Schmidt
P.E. No. 43409

RW BUILDING CONSULTANTS, INC.
P.O. Box 230, Vairico, FL 33595
Phone No.: 813.659.9197
FBPE Registry No. 9813

PRODUCT: THERMA-TRU

PART OR ASSEMBLY: ELEVATIONS

| NO. | DATE | BY | REVISIONS |
|-----|------|----|-----------|
| | | | |
| | | | |
| | | | |
| | | | |
| | | | |

| | |
|--------------|------------|
| DATE: | 2/07/24 |
| SCALE: | N.T.S. |
| DWG. BY: | LFS |
| CHK. BY: | RW |
| DRAWING NO.: | FL-46172.9 |
| SHEET | 3 OF 12 |

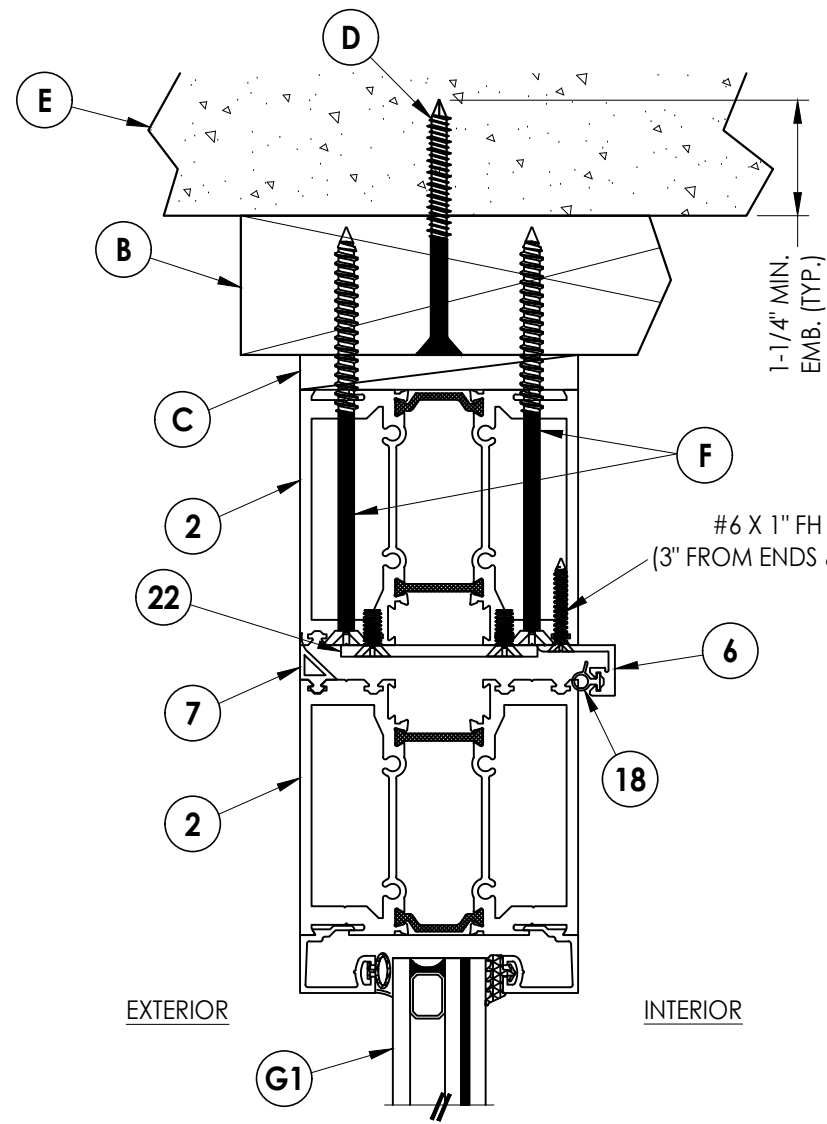

1 VERTICAL CROSS SECTION
4 Shown w/ 2X Buck

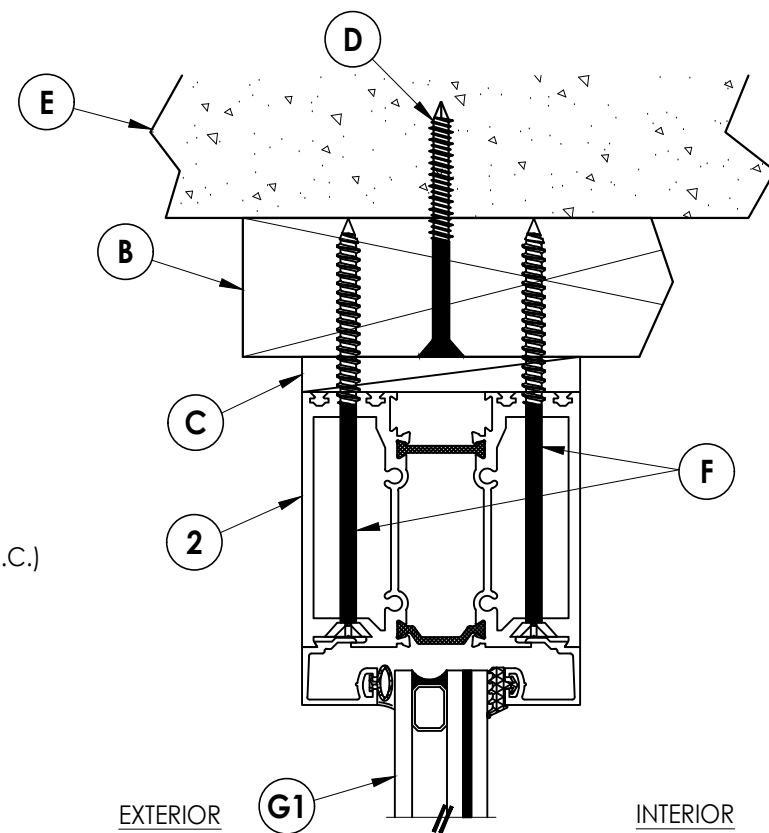

2 VERTICAL CROSS SECTION
4 Shown w/ 2X Buck

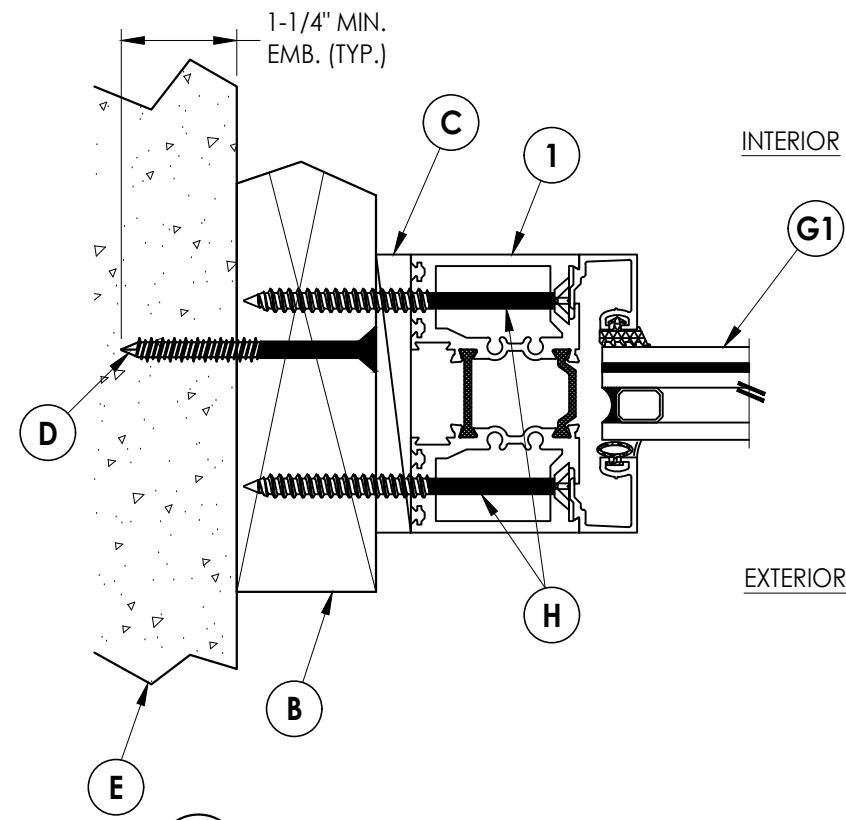

3 HORIZONTAL CROSS SECTION
4 Shown w/ 2X Buck

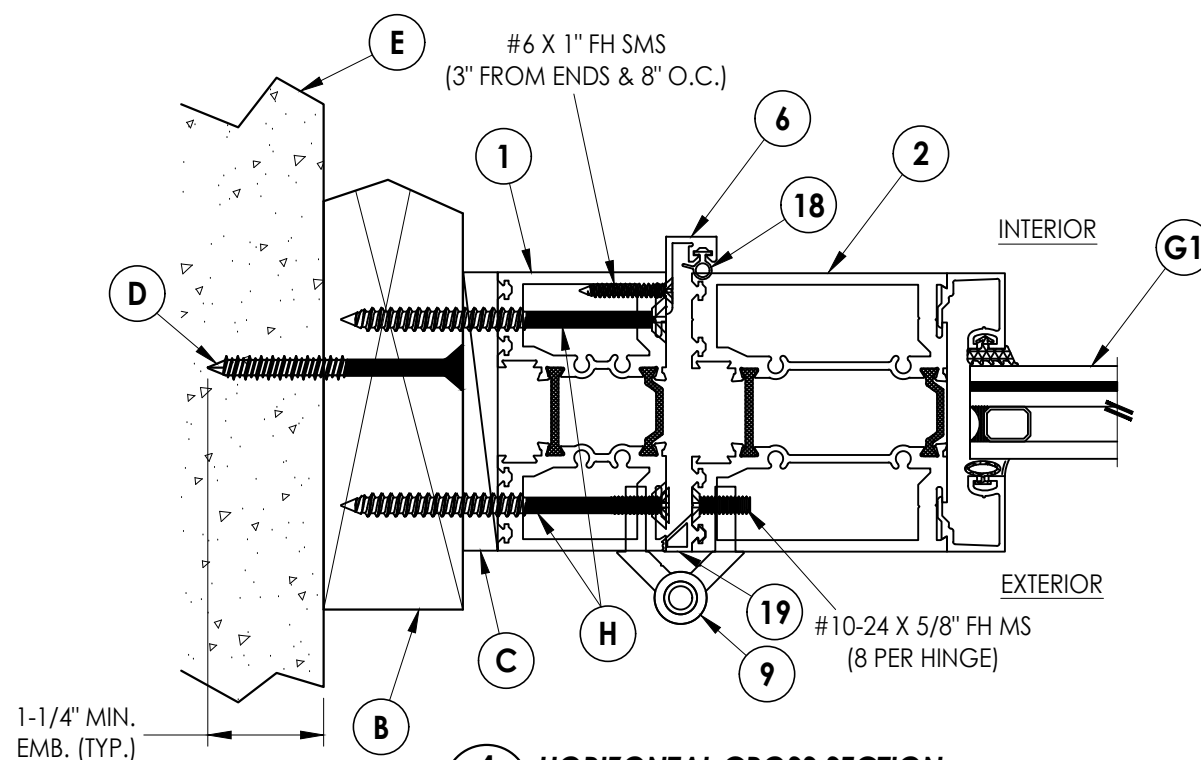

4 HORIZONTAL CROSS SECTION
4 Shown w/ 2X Buck

Documents Prepared By:
Lyndon F. Schmidt
P.E. No. 43409

RW BUILDING CONSULTANTS, INC.
P.O. Box 230, Vairico, FL 33595
Phone No.: 813.659.9197
FBPE Registry No. 9813

PRODUCT: THERMA-TRU
PART OR ASSEMBLY: HORIZONTAL & VERTICAL CROSS SECTIONS (2X BUCK)

| NO. | DATE | BY | REVISIONS |
|-----|------|----|-----------|
| | | | |
| | | | |
| | | | |
| | | | |

DATE: 2/07/24
SCALE: N.T.S.
DWG. BY: LFS
CHK. BY: RW
DRAWING NO.: FL-46172.9
SHEET 4 OF 12

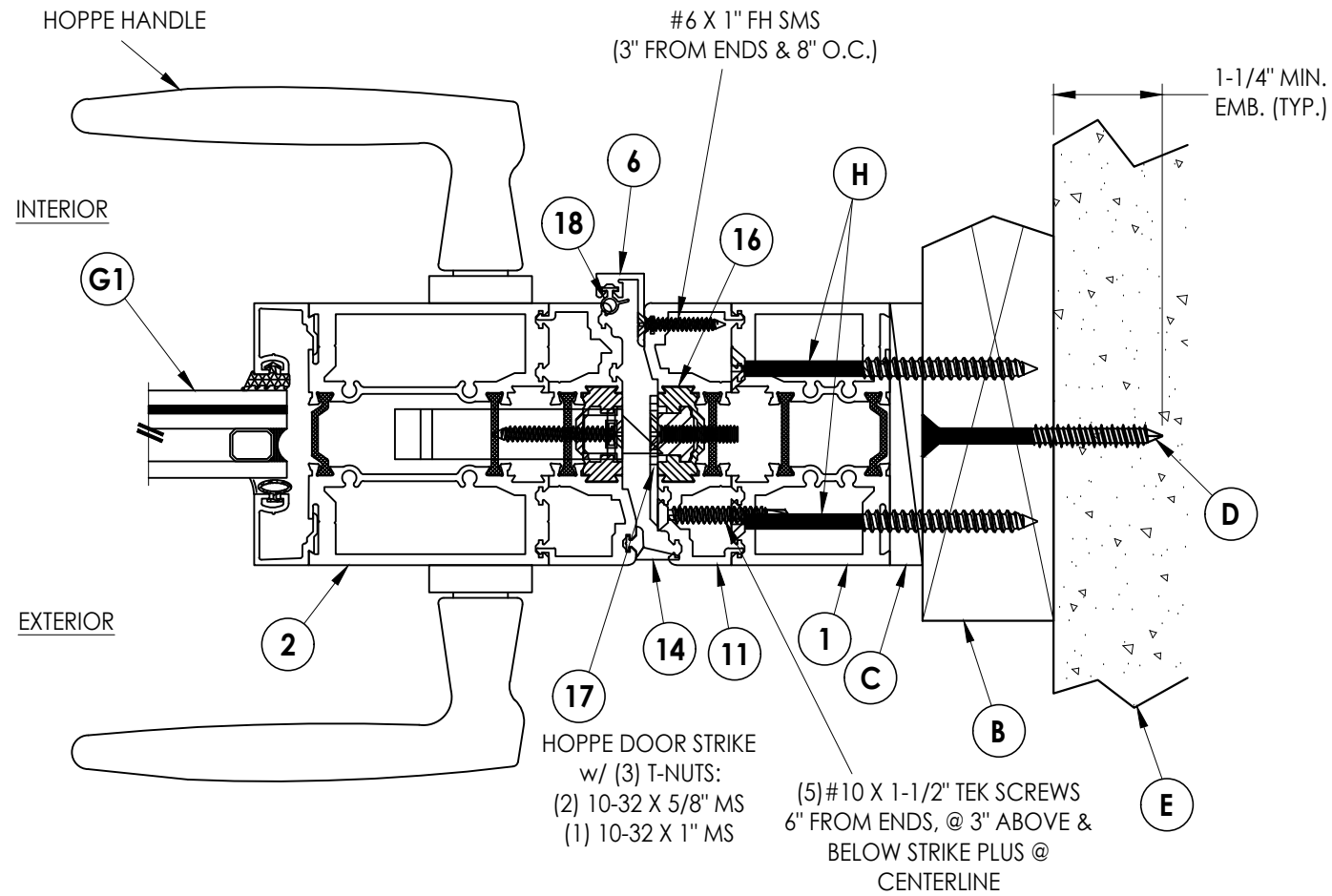

1 HORIZONTAL CROSS SECTION
5 Shown w/ 2X Buck

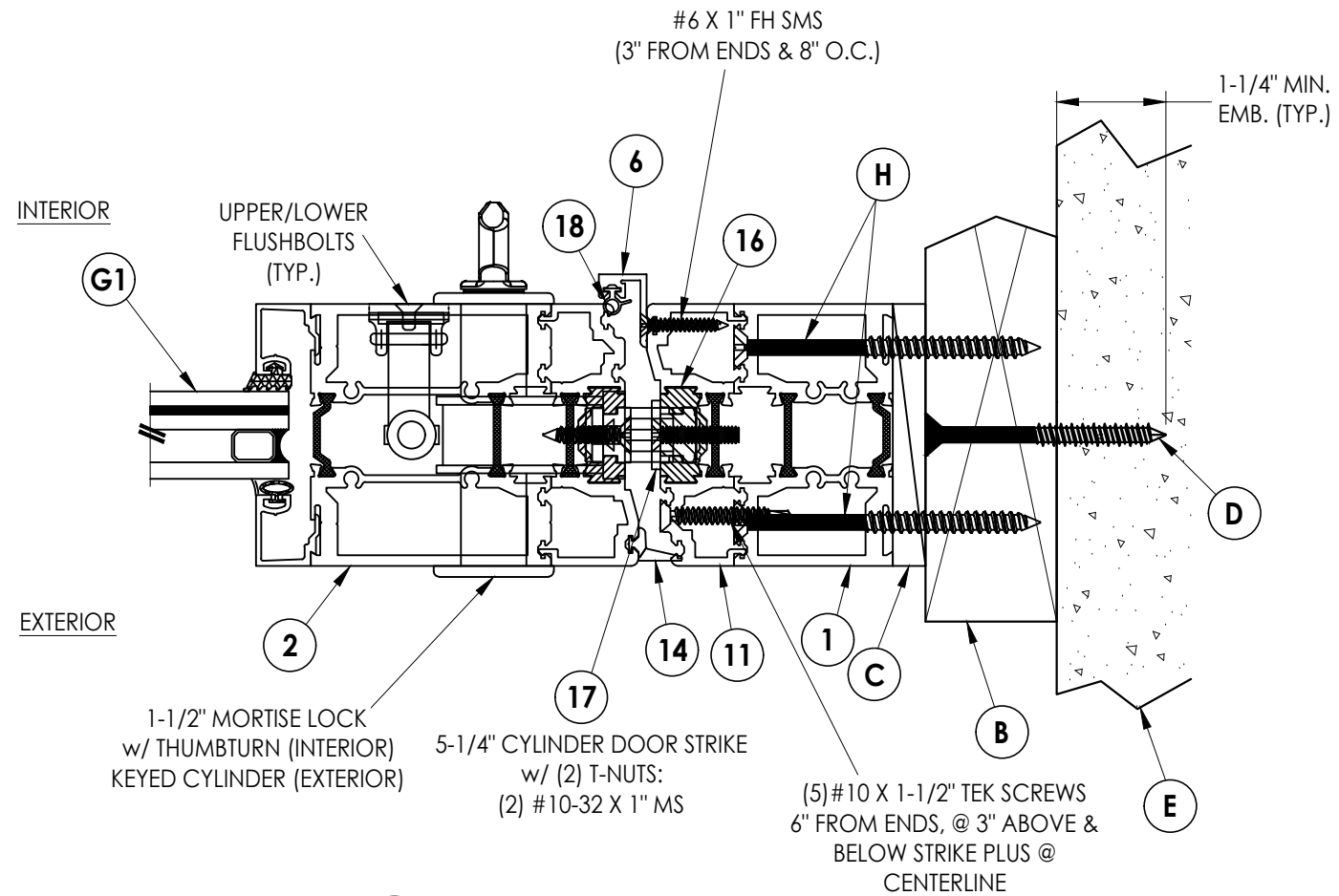

2 HORIZONTAL CROSS SECTION
5 Shown w/ 2X Buck

Documents Prepared By:
Lyndon F. Schmidt
P.E. No. 43409

RW BUILDING CONSULTANTS, INC.
P.O. Box 230, Vairico, FL 33595
Phone No.: 813.659.9197
FBPE Registry No. 9813

PRODUCT: THERMA-TRU

PART OR ASSEMBLY:
HORIZONTAL CROSS
SECTIONS (2X BUCK)

| NO. | DATE | BY | REVISIONS |
|-----|------|----|-----------|
| | | | |
| | | | |
| | | | |
| | | | |

DATE: 2/07/24
SCALE: N.T.S.
DWG. BY: LFS
CHK. BY: RW
DRAWING NO.:
FL-46172.9
SHEET 5 OF 12

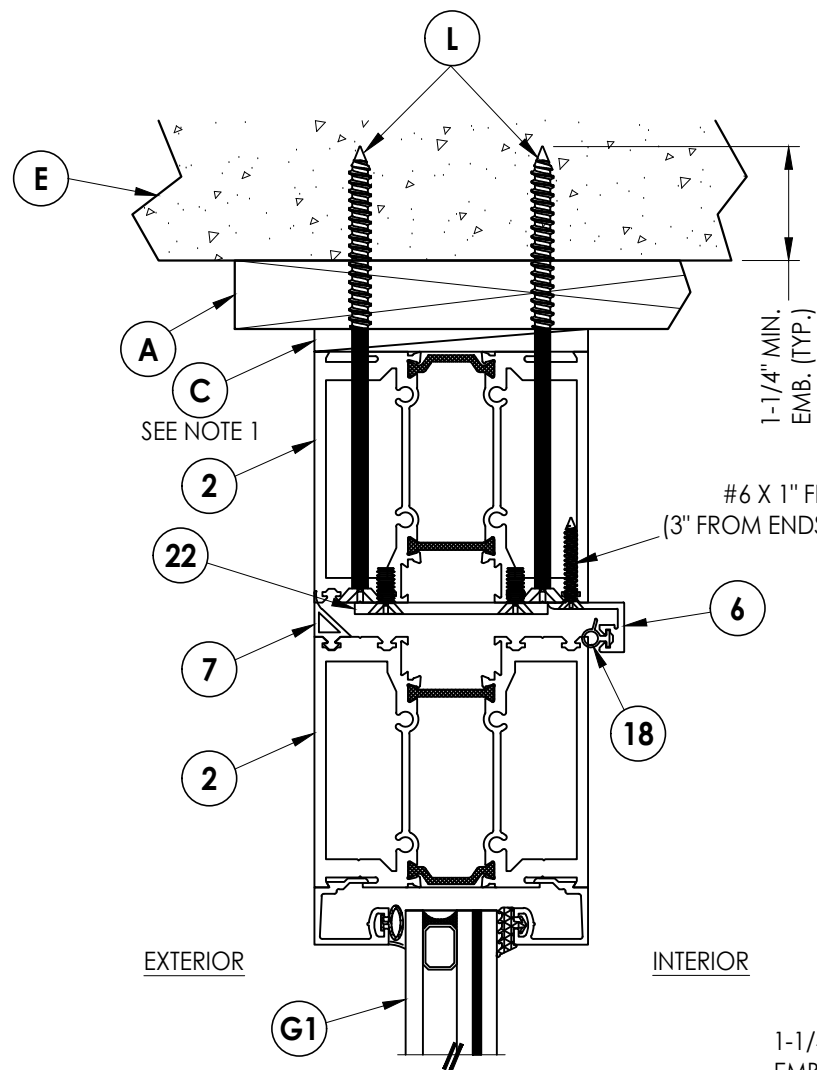

1 VERTICAL CROSS SECTION
6 Shown w/ 1X Buck

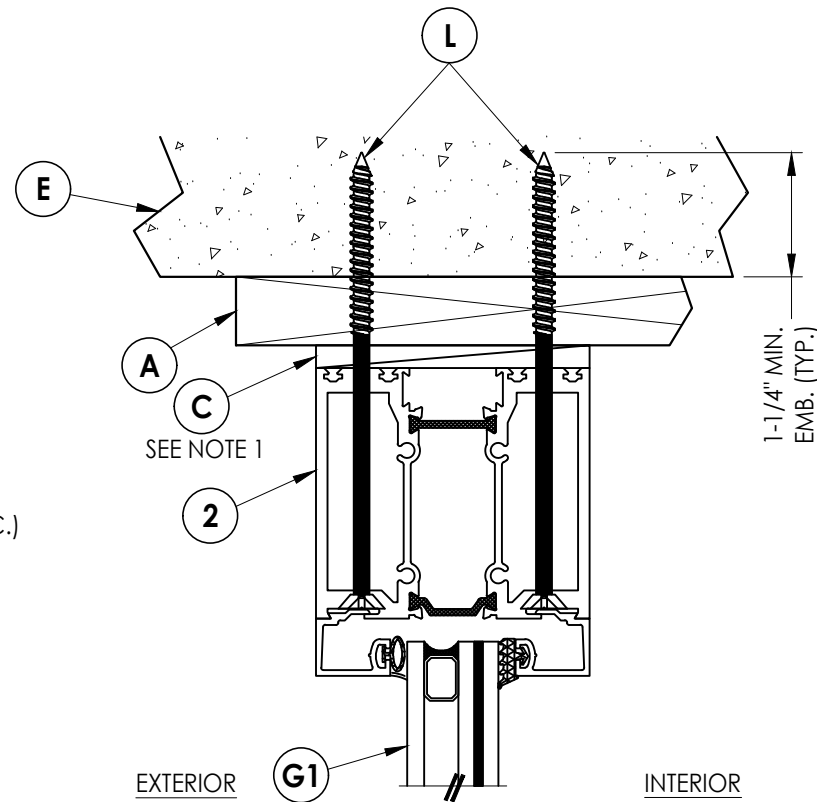

2 VERTICAL CROSS SECTION
6 Shown w/ 1X Buck

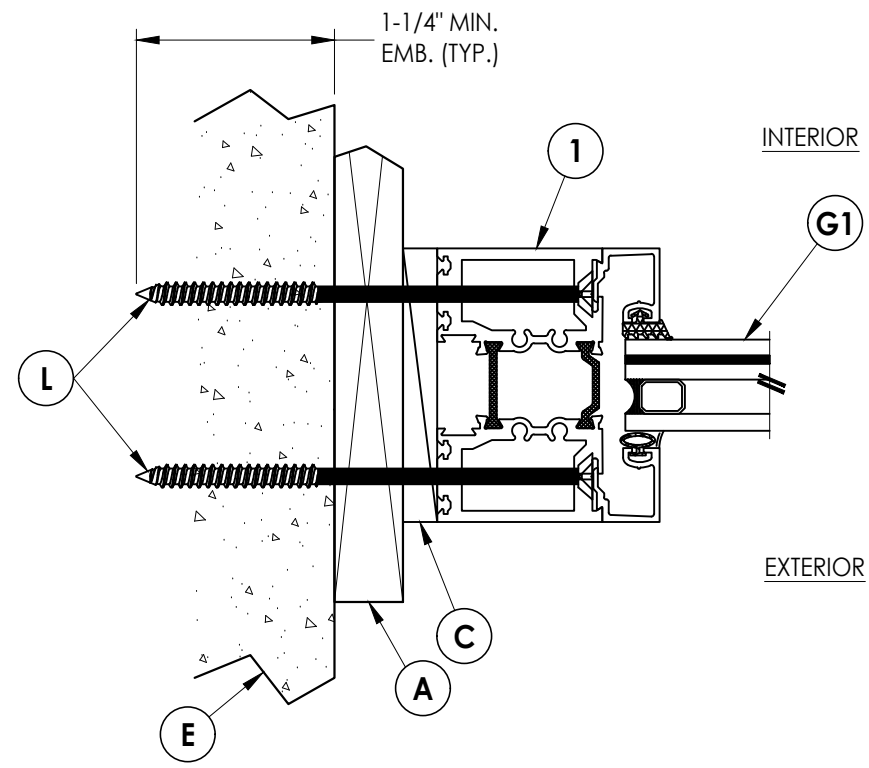

3 HORIZONTAL CROSS SECTION
6 Shown w/ 1X Buck

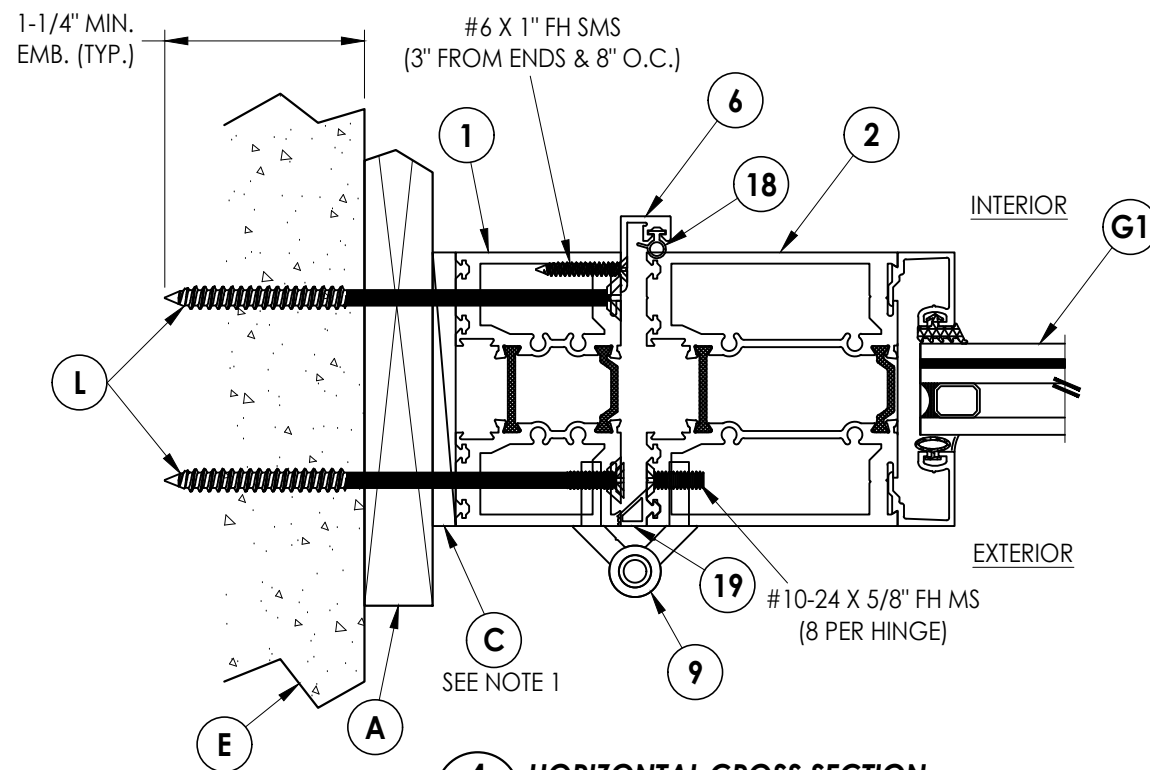

4 HORIZONTAL CROSS SECTION
6 Shown w/ 1X Buck

NOTE:
1. MAXIMUM 1/4" SHIM @ HEAD & JAMBS w/ 1X BUCK AS SHOWN.

Documents Prepared By:
Lyndon F. Schmidt
P.E. No. 43409

RW BUILDING CONSULTANTS, INC.
P.O. Box 230, Valrico, FL 33595
Phone No.: 813.659.9197
FBPE Registry No. 9813

PRODUCT: THERMA-TRU
PART OR ASSEMBLY:
HORIZONTAL & VERTICAL
CROSS SECTIONS (1X BUCK)

| NO. | DATE | BY |
|-----|------|----|
| | | |
| | | |
| | | |
| | | |

DATE: 2/07/24
SCALE: N.T.S.
DWG. BY: LFS
CHK. BY: RW
DRAWING NO.: FL-46172.9
SHEET 6 OF 12

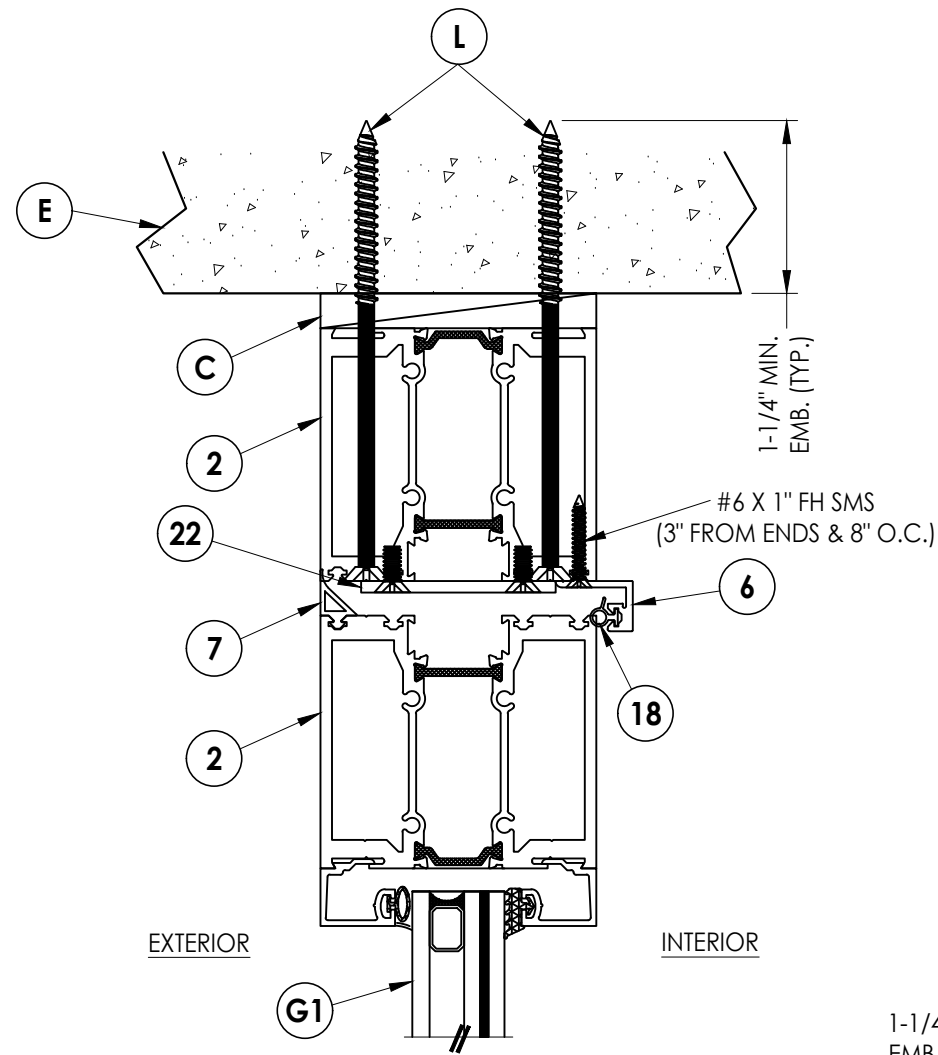

1
7 **VERTICAL CROSS SECTION**
Shown Direct to Masonry

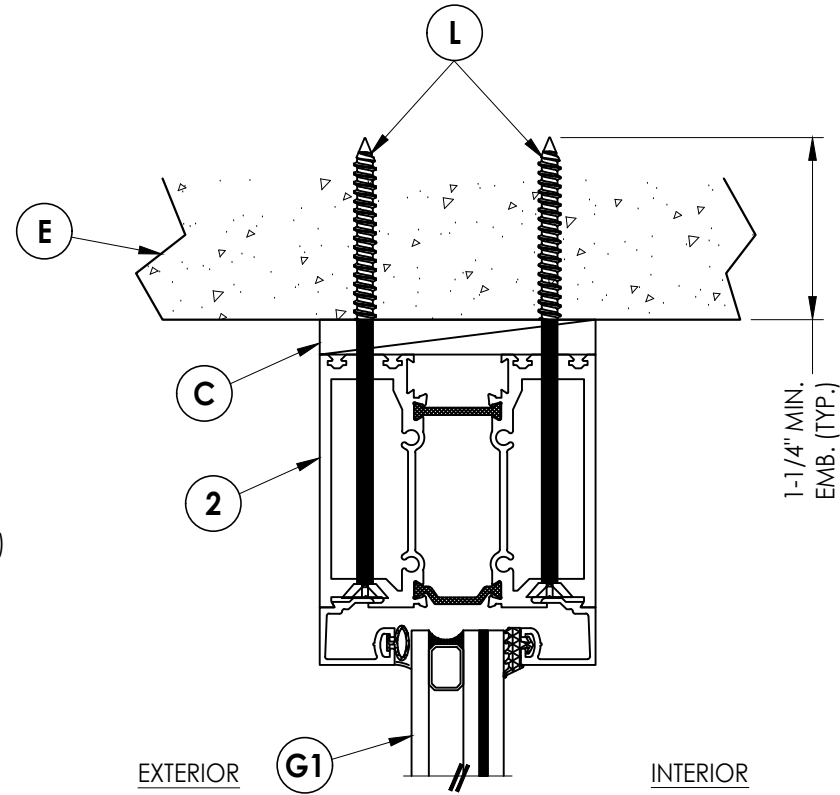

2
7 **VERTICAL CROSS SECTION**
Shown Direct to Masonry

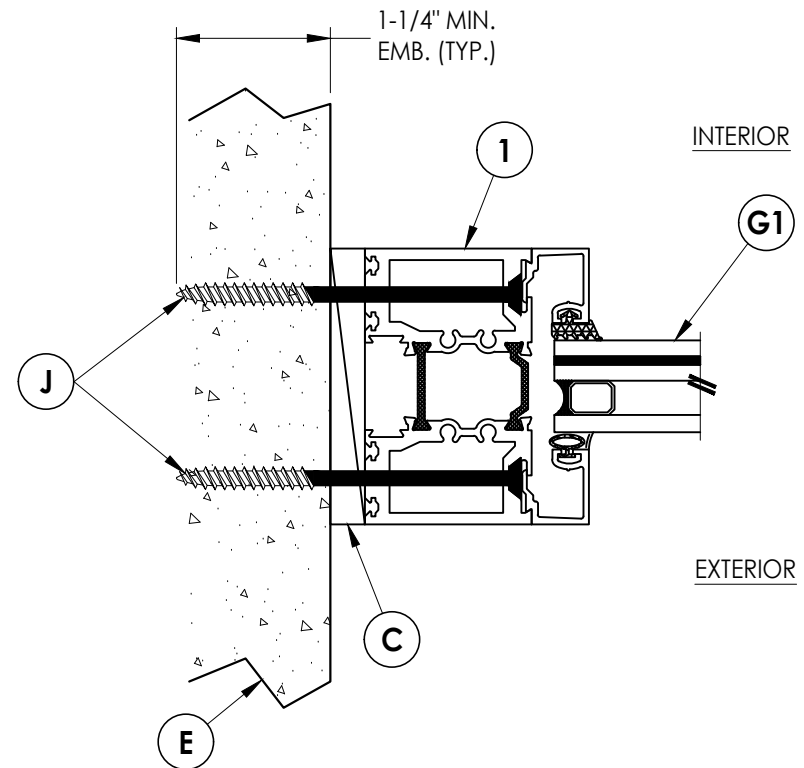

3
7 **HORIZONTAL CROSS SECTION**
Shown Direct to Masonry

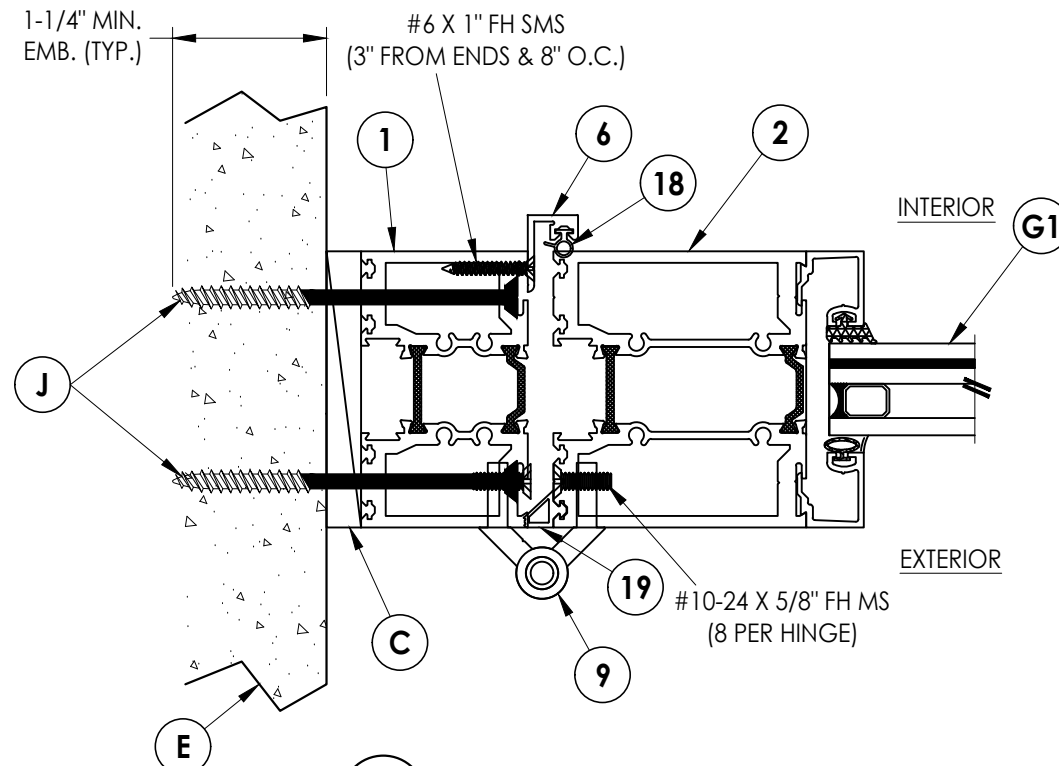

4
7 **HORIZONTAL CROSS SECTION**
Shown Direct to Masonry

Documents Prepared By:
Lyndon F. Schmidt
P.E. No. 43409

RW BUILDING CONSULTANTS, INC.
P.O. Box 230, Valrico, FL 33595
Phone No.: 813.659.9197
FBPE Registry No. 9813

PRODUCT: THERMA-TRU

PART OR ASSEMBLY:
HORIZONTAL & VERTICAL CROSS
SECTIONS (DIRECT TO MASONRY)

| NO. | DATE | BY |
|-----|------|----|
| | | |
| | | |
| | | |
| | | |
| | | |

DATE: 2/07/24
SCALE: N.T.S.
DWG. BY: LFS
CHK. BY: RW
DRAWING NO.: FL-46172.9
SHEET 7 OF 12

Z:\2023 FBC Drawings\Therma-Tru\FL-46172\FL 46172.9.dwg

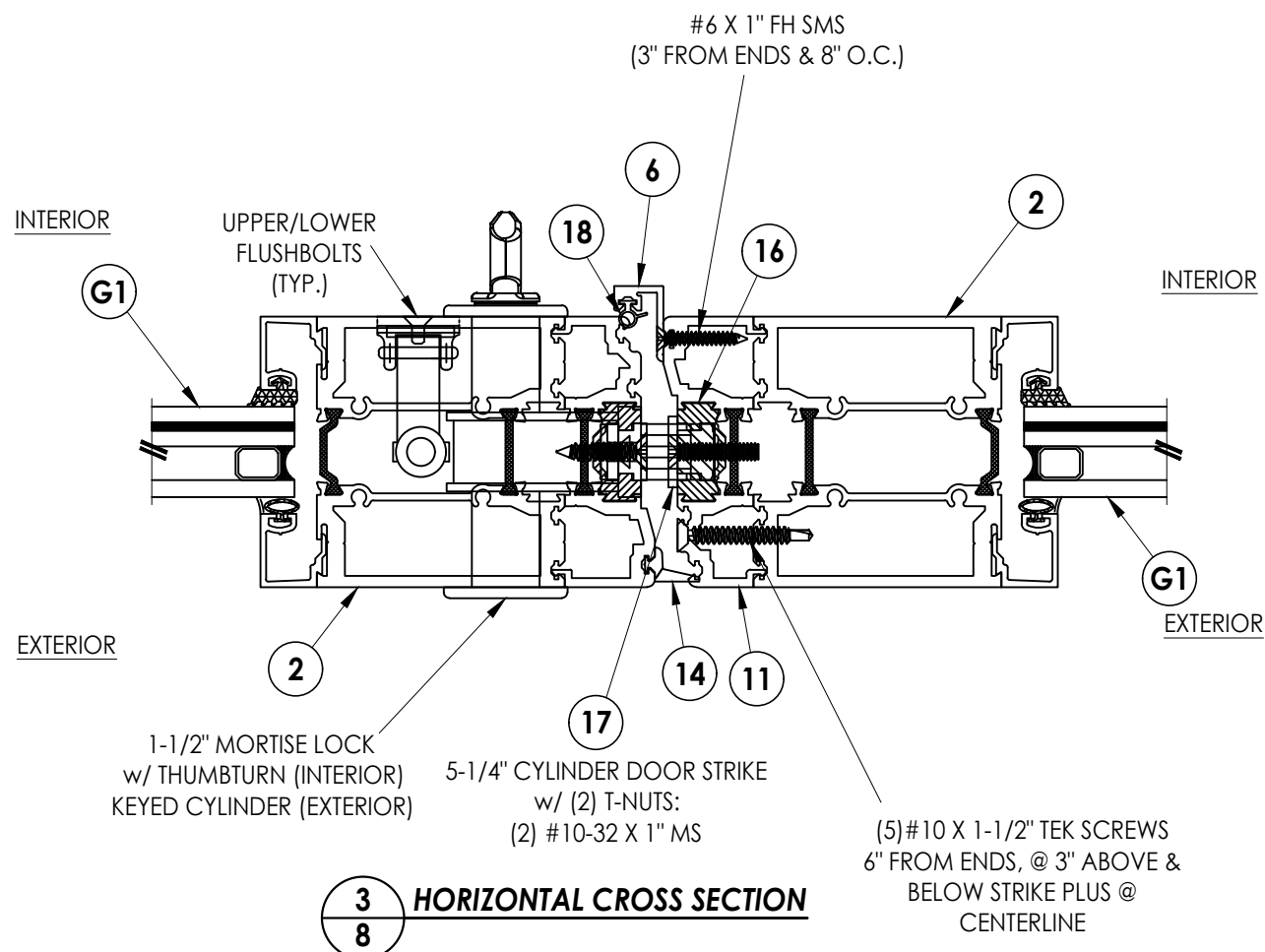
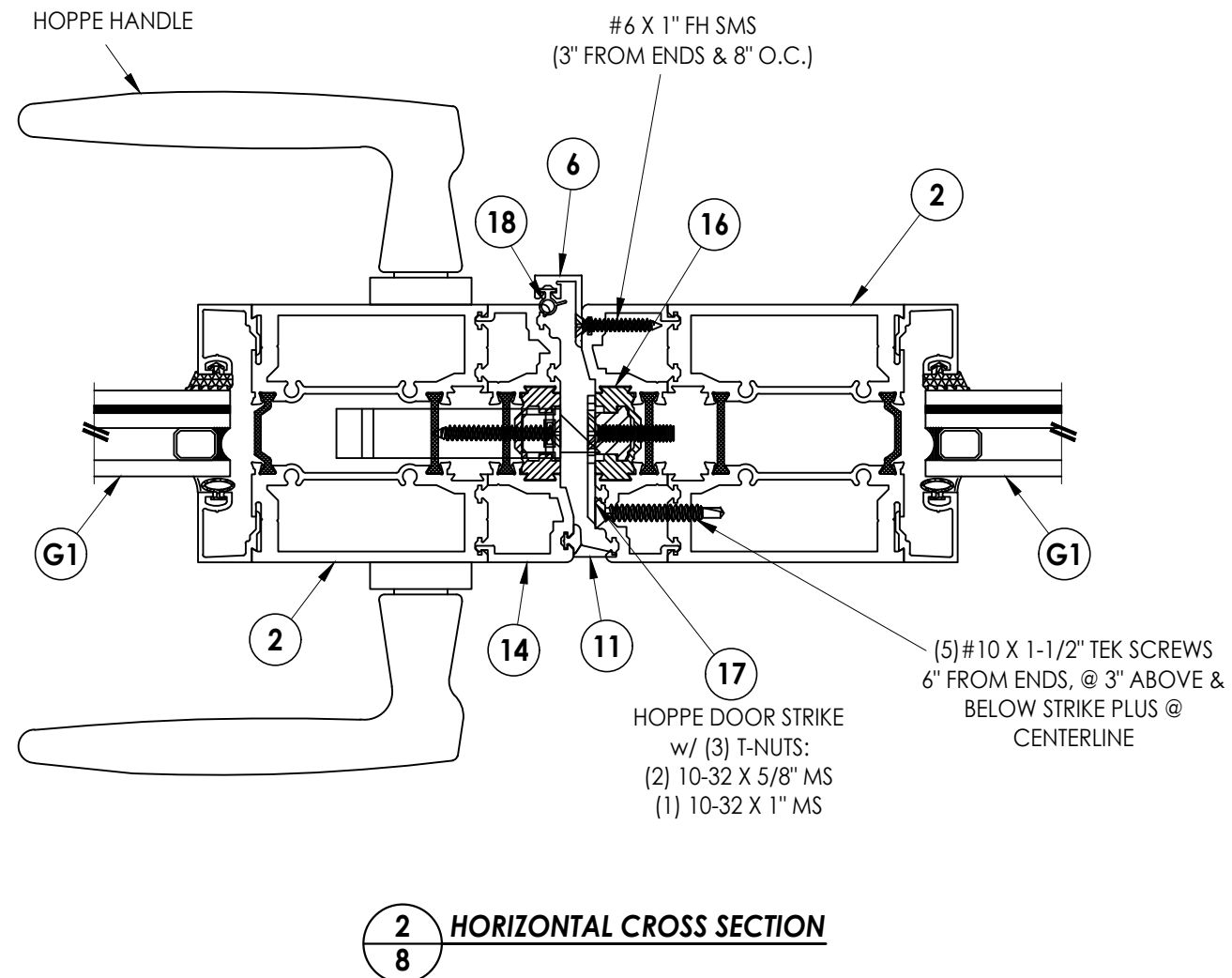
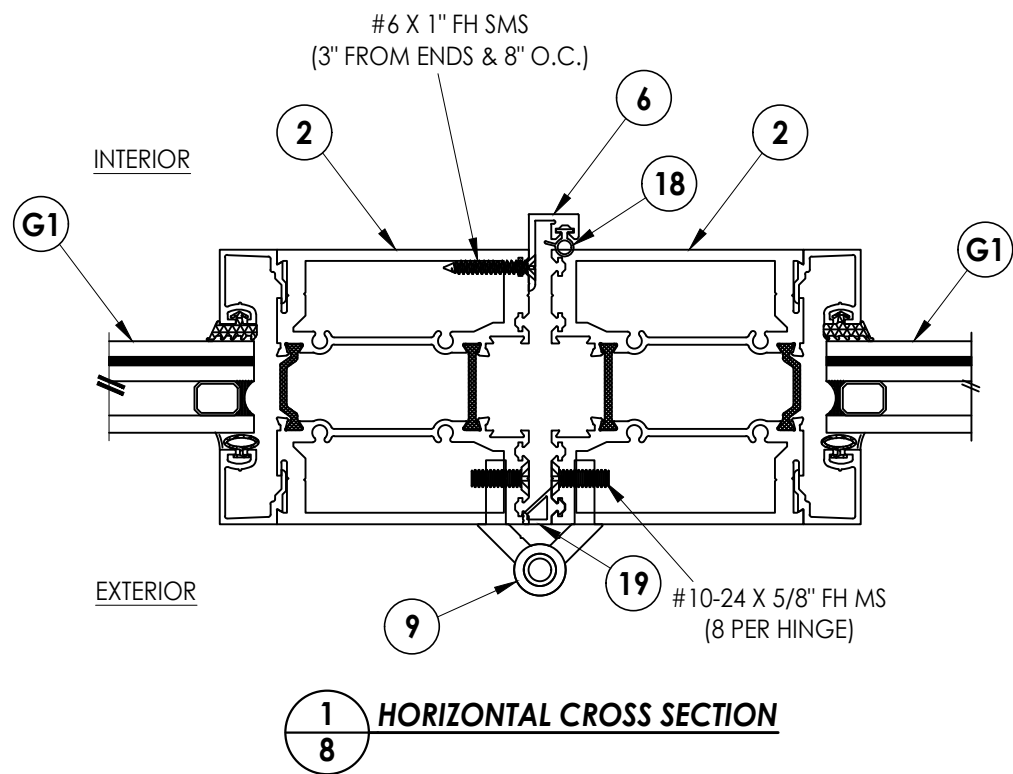

Documents Prepared By:
Lyndon F. Schmidt
P.E. No. 43409

RW BUILDING CONSULTANTS, INC.
P.O. Box 230, Valrico, FL 33595
Phone No.: 813.659.9197
FBPE Registry No. 9813

| | |
|-------------------|---------------------------|
| PRODUCT: | Therma-TRU |
| PART OR ASSEMBLY: | HORIZONTAL CROSS SECTIONS |

| NO. | DATE | BY | REVISIONS |
|-----|------|----|-----------|
| | | | |
| | | | |
| | | | |
| | | | |

| | |
|--------------|------------|
| DATE: | 2/07/24 |
| SCALE: | N.T.S. |
| DWG. BY: | LFS |
| CHK. BY: | RW |
| DRAWING NO.: | FL-46172.9 |
| SHEET | 8 OF 12 |

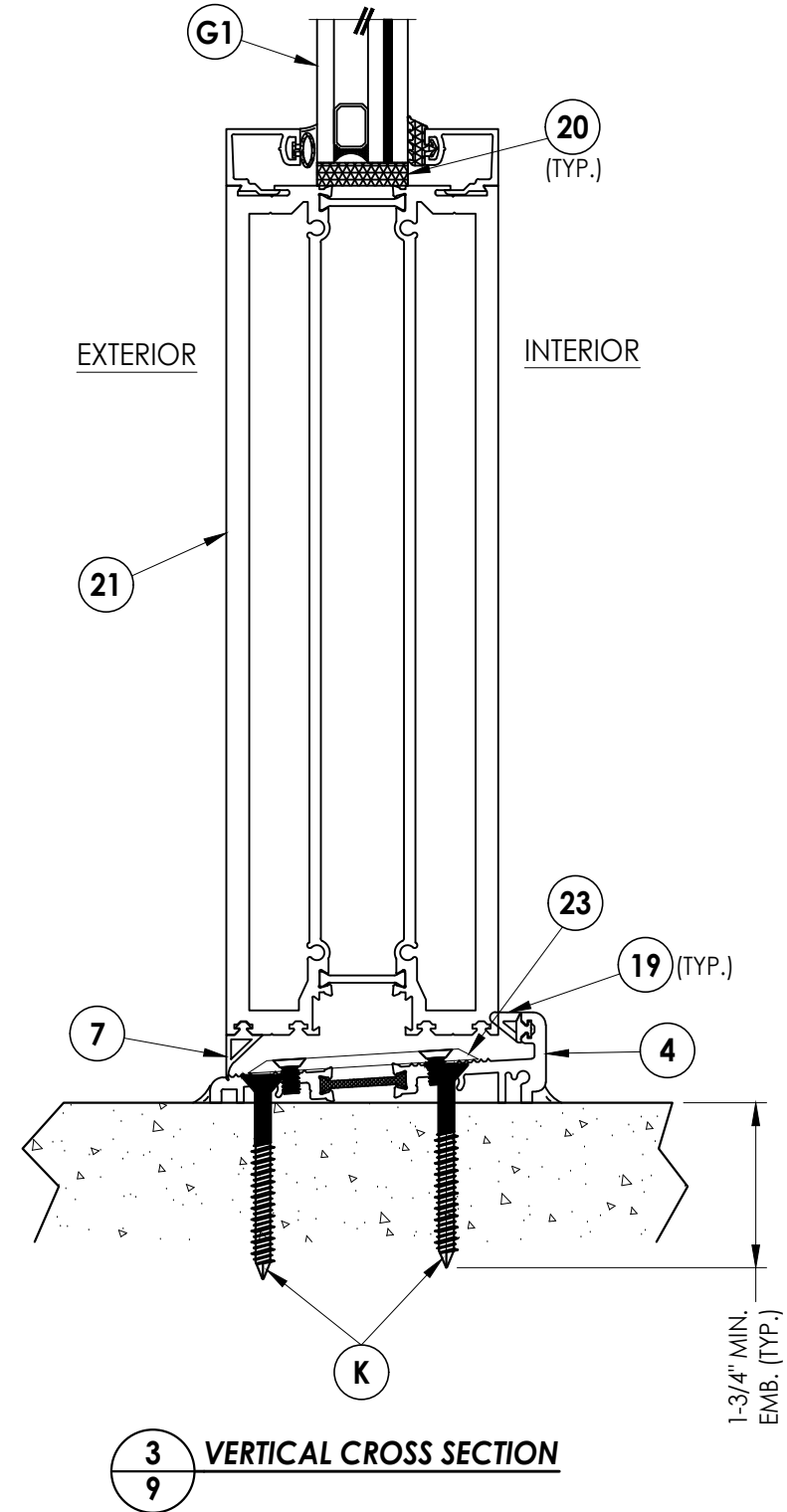
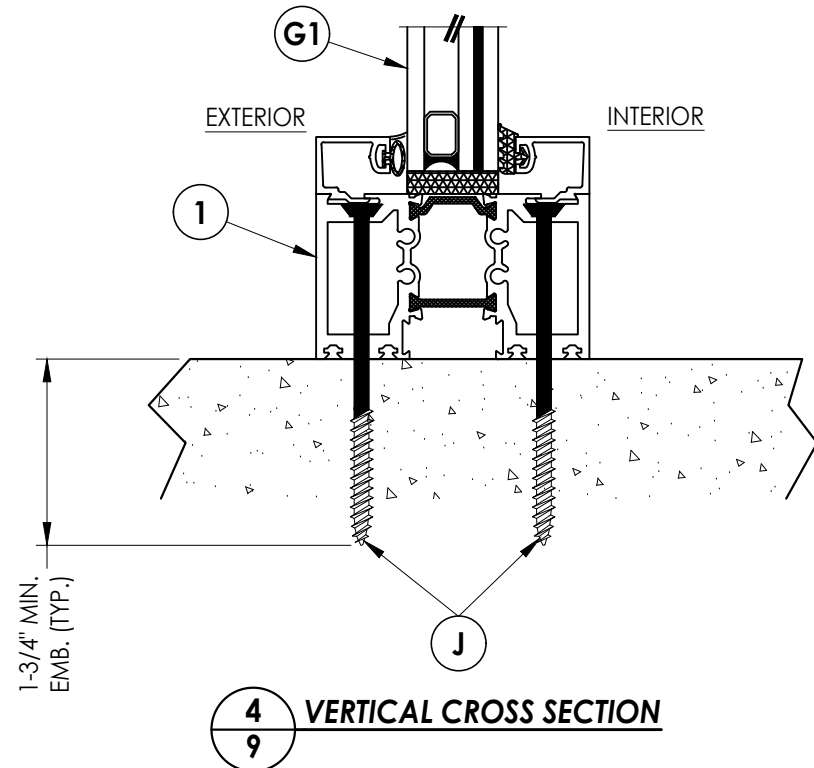
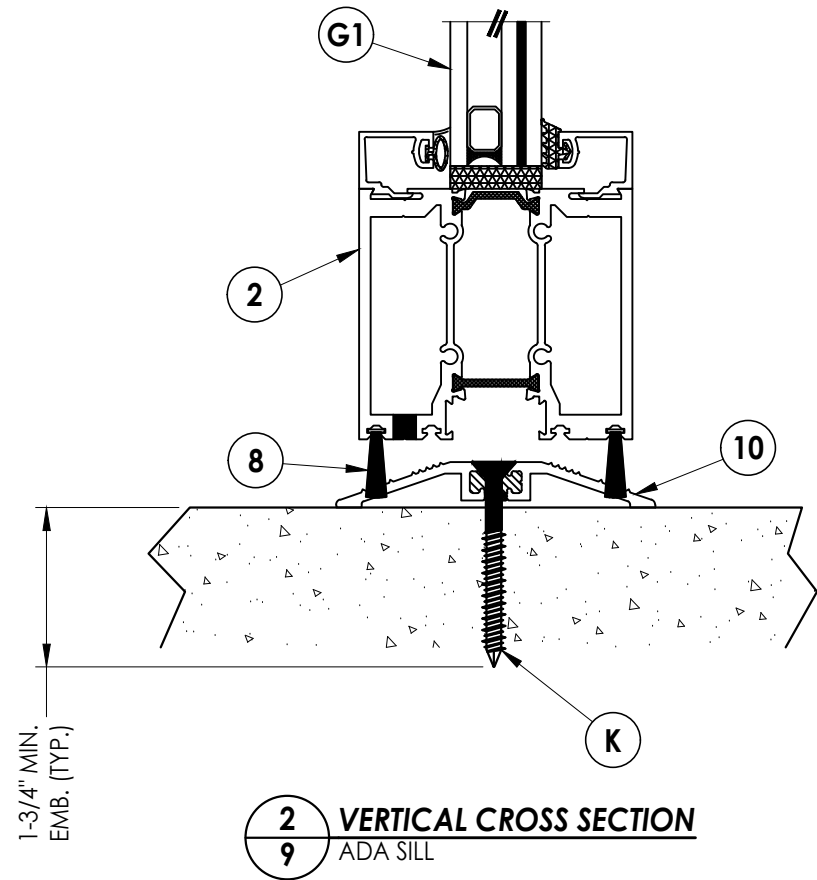
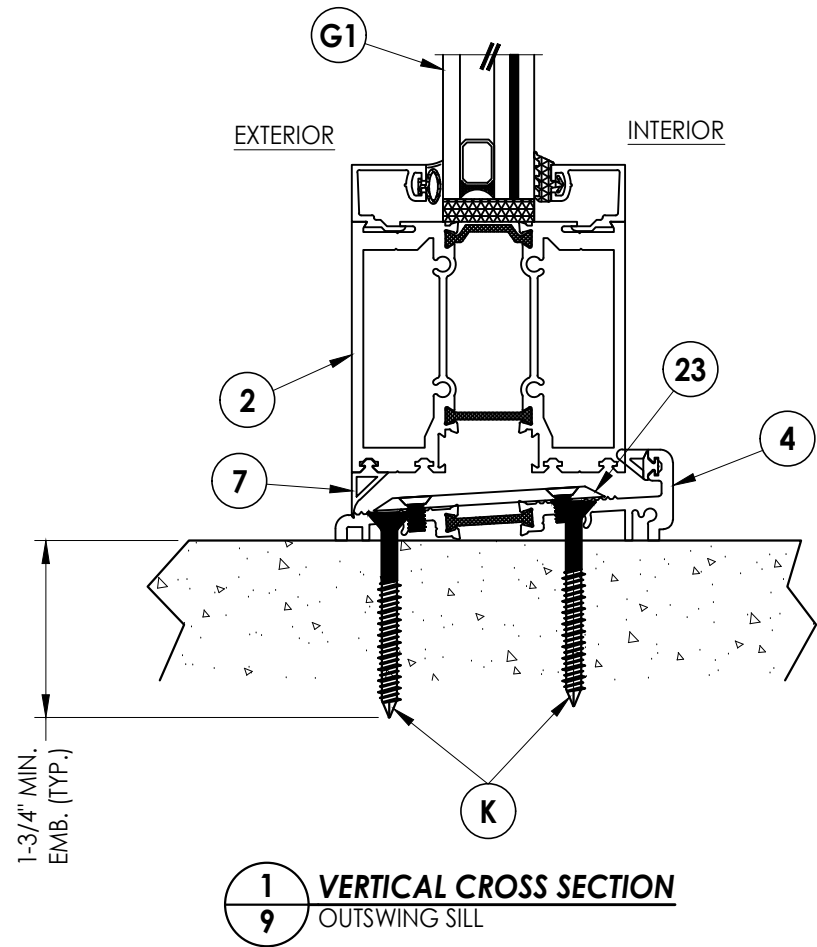

Documents Prepared By:
Lyndon F. Schmidt
P.E. No. 43409

RW BUILDING CONSULTANTS, INC.
P.O. Box 230, Valrico, FL 33595
Phone No.: 813.659.9197
FBPE Registry No. 9813

PRODUCT: THERMA-TRU

PART OR ASSEMBLY:
VERTICAL CROSS SECTIONS

| NO. | DATE | BY |
|-----|------|----|
| | | |
| | | |
| | | |
| | | |

DATE: 2/07/24
SCALE: N.T.S.
DWG. BY: JK
CHK. BY: RW
DRAWING NO.: FL-46172.9
SHEET 9 OF 12

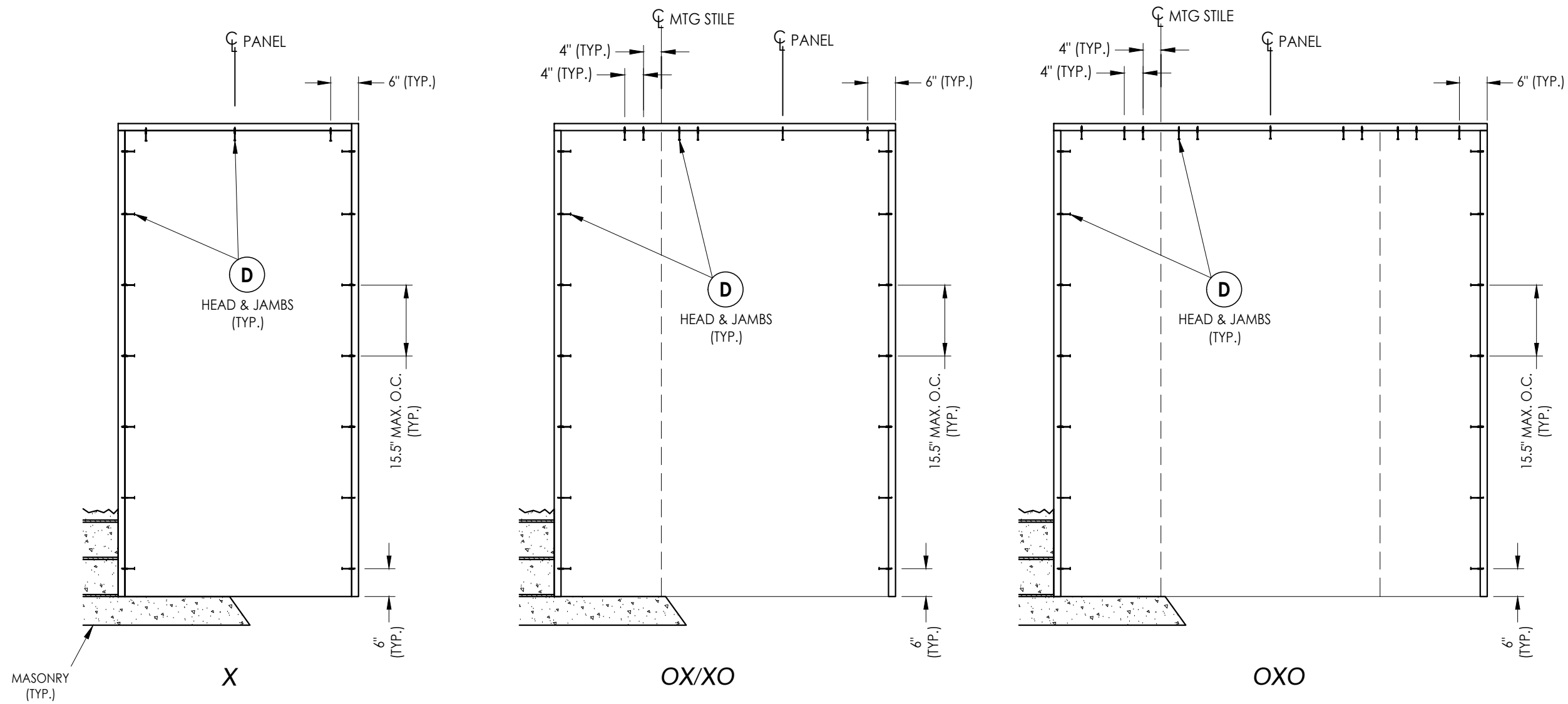

2X BUCK ANCHORING

CONCRETE ANCHOR NOTES:

1. Concrete anchor locations at the corners may be adjusted to maintain the min. edge distance to mortar joints.
2. Concrete anchor locations noted as "MAX. ON CENTER" must be adjusted to maintain the min. edge distance to mortar joints, additional concrete anchors may be required to ensure the "MAX. ON CENTER" dimension are not exceeded.
3. Concrete anchor table:

| ANCHOR TYPE | ANCHOR SIZE | MIN. EMBEDMENT | MIN. CLEARANCE TO MASONRY EDGE | MIN. CLEARANCE TO ADJACENT ANCHOR |
|------------------|-------------|-------------------------|--------------------------------|-----------------------------------|
| ITW TAPCON® | 1/4" | 1-1/4" 1-3/4" (SILL) | 2" | 4" |
| DeWALT ULTRACON® | 1/4" | 1-1/4" 1-3/4" (SILL) | 1" | 4" |

WOOD SCREW INSTALLATION NOTES:

1. Maintain a minimum 5/8" edge distance, 1" end distance, & 1" o.c. spacing of wood screws to prevent the splitting of wood.

Documents Prepared By:
Lyndon F. Schmidt
P.E. No. 43409

RW BUILDING CONSULTANTS, INC.
P.O. Box 230, Vairico, FL 33595
Phone No.: 813.659.9197
FBPE Registry No. 9813

PRODUCT: THERMA TRU

PART OR ASSEMBLY:
BUCK ANCHORING

| NO. | DATE | BY |
|-----|------|----|
| | | |
| | | |
| | | |
| | | |
| | | |
| | | |
| | | |
| | | |
| | | |
| | | |

DATE: 2/07/24

SCALE: N.T.S.

DWG. BY: JK

CHK. BY: RW

DRAWING NO.:

FL-46172.9

SHEET 10 OF 12

NOTE: ALL ANCHORS SHOWN ARE STAGGERED EXCEPT FOR THE ADA SILL ANCHORS (SEE CROSS-SECTIONS)

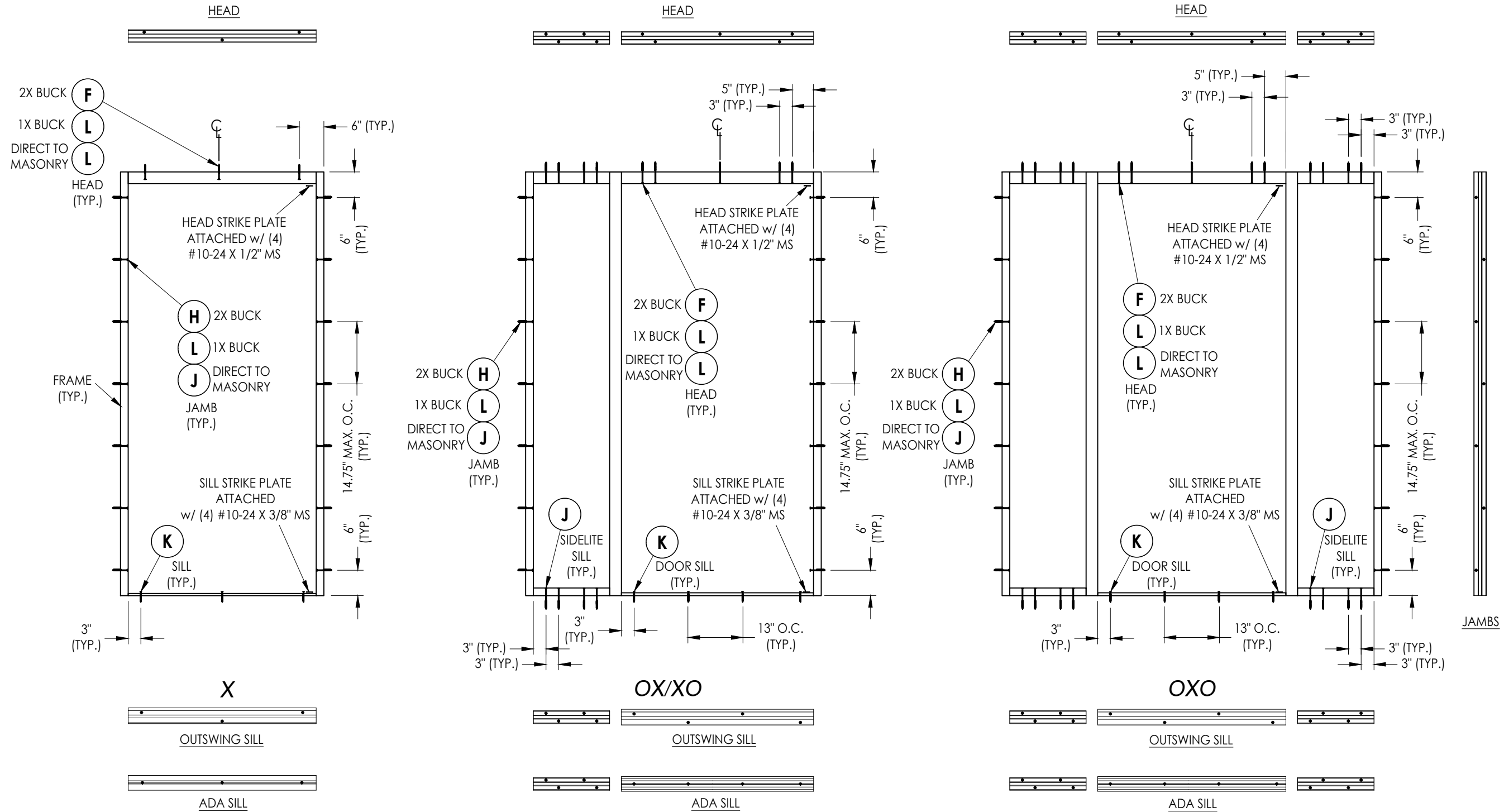

FRAME ANCHORING

Documents Prepared By:
Lyndon F. Schmidt
P.E. No. 43409

RW BUILDING CONSULTANTS, INC.
P.O. Box 230, Valrico, FL 33595
Phone No.: 813.659.9197
FBPE Registry No. 9813

PRODUCT: THERMA TRU

PART OR ASSEMBLY: FRAME ANCHORING

| NO. | DATE | BY |
|-----|------|----|
| | | |
| | | |
| | | |
| | | |

DATE: 2/07/24
SCALE: N.T.S.
DWG. BY: JK
CHK. BY: RW
DRAWING NO.: FL-46172.9
SHEET 11 OF 12

BILL OF MATERIALS

| ITEM | DESCRIPTION | MATERIAL |
|------|--|--------------|
| A | 1X BUCK (SG >= 0.42) | WOOD |
| B | 2X BUCK (SG >= 0.42) | WOOD |
| C | 3/8" MAX. SHIM SPACE | - |
| D | 1/4" X 2-3/4" PFH DeWALT OR ITW CONCRETE SCREW | STEEL |
| E | MASONRY - 3,000 PSI MIN. CONCRETE CONFORMING TO ACI 301 OR HOLLOW BLOCK CONFORMING TO ASTM C90 | CONCRETE |
| F | #14 X 4-1/2" FH SMS (1-1/4" MIN. EMBEDMENT) | S.S. |
| H | #14 X 3-1/2" FH SMS (1-1/4" MIN. EMBEDMENT) | S.S. |
| J | 1/4" X 3-3/4" PFH DeWALT OR ITW CONCRETE SCREW | STEEL |
| K | 1/4" X 2-1/4" PFH DeWALT OR ITW CONCRETE SCREW | STEEL |
| L | 1/4" X 5" PFH DeWALT OR ITW CONCRETE SCREW | STEEL |
| 1 | LT NARROW FRAME | 6063-T6 ALUM |
| 2 | LT FRAME | 6063-T6 ALUM |
| 4 | OUTSWING SILL | 6063-T6 ALUM |
| 5 | 1/4" GLASS STOP | 6063-T6 ALUM |
| 6 | SLIDE-IN DOOR STOP | 6063-T5 ALUM |
| 7 | DOOR SILL GASKET | - |
| 8 | 3/4" BRUSH WEATHERSTRIP | - |
| 9 | SEMI-CONCEALED HINGE | 6105-T5 ALUM |
| 10 | ADA SILL | 6063-T5 ALUM |
| 11 | SWING DOOR ADAPTER | 6063-T6 ALUM |
| 14 | DOOR SWEEP FOAM GASKET | - |
| 16 | 16mm EUROGROOVE | - |
| 17 | HOPPE DOOR STRIKE | S.S. |
| 18 | BULB GASKET | - |
| 19 | DOOR GASKET | - |
| 20 | SETTING BLOCK | - |
| 21 | DOOR BOTTOM PANEL | 6063-T5 ALUM |
| 22 | STRIKE PLATE (@ HEAD) | S.S. |
| 23 | STRIKE PLATE (@ SILL) | S.S. |

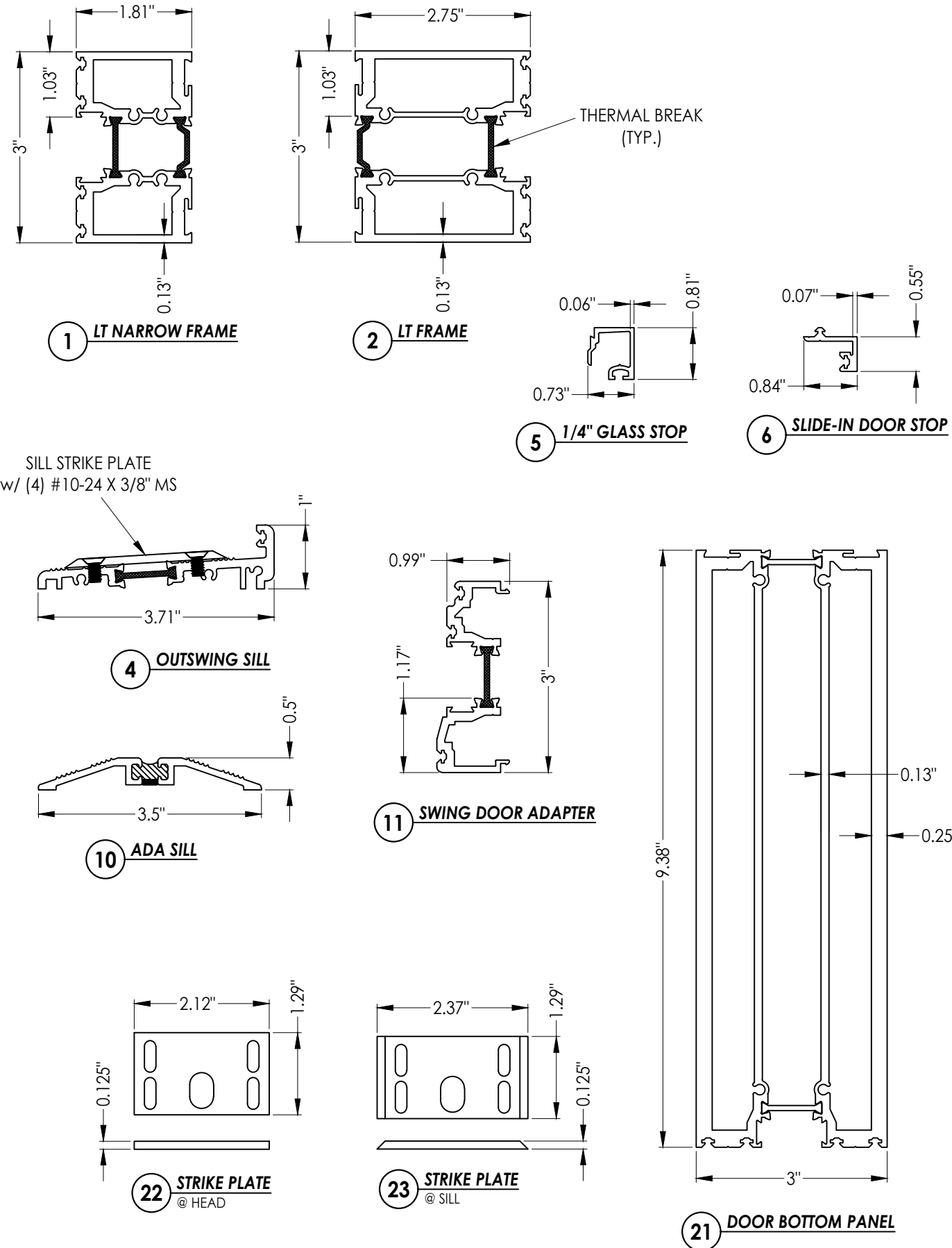

Documents Prepared By:
Lyndon F. Schmidt
P.E. No. 43409

RW BUILDING CONSULTANTS, INC.
P.O. Box 230, Valrico, FL 33595
Phone No.: 813.659.9197
FBPE Registry No. 9813

PRODUCT: THERMA TRU
PART OR ASSEMBLY: BILL OF MATERIAL & COMPONENTS

| NO. | DATE | BY | REVISIONS |
|-----|------|----|-----------|
| | | | |
| | | | |
| | | | |
| | | | |

DATE: 2/07/24
SCALE: N.T.S.
DWG. BY: JK
CHK. BY: RW
DRAWING NO.: FL-46172.9
SHEET 12 of 12